

Smart Watch

Manual



Table of Contents

Note: Please carefully read the instruction before use your watch!

1. Button functions.....	3
2. Features / Functions	4
3. Manual instructions	5
3.1. Power ON/OFF mode.....	5
3.2. Bluetooth ON/OFF mode	5
3.3. Review your records	6
3.4. Check the humidity, altitude and UV by your phone	6
3.5. Alarm mode.....	8
3.6. Stopwatch mode	9
3.7. Time & 12/24H format setting	10
3.8. Calendar setting	11
3.9. Take photo by watch remote control	11
4. App instruction manual	12
4.1. App installation	12
4.2. Connect your watch to your mobile	13
4.3. Search for your device	13
4.4. Search for your mobile	13
4.5. Reset your data.....	14
4.6. Personal settings	14
4.7. Alarm setting	14
4.8. Notifications.....	14
4.9. Synchronizing and data review	15
4.10. Sharing exercises	15
4.11. About us	15
5. APP download	16

1. Button functions

Button A : EL backlight & Bluetooth ON/OFF

Button B : Mode shifting & functions review

Button C : Confirm & start

Button D : Pause & reset

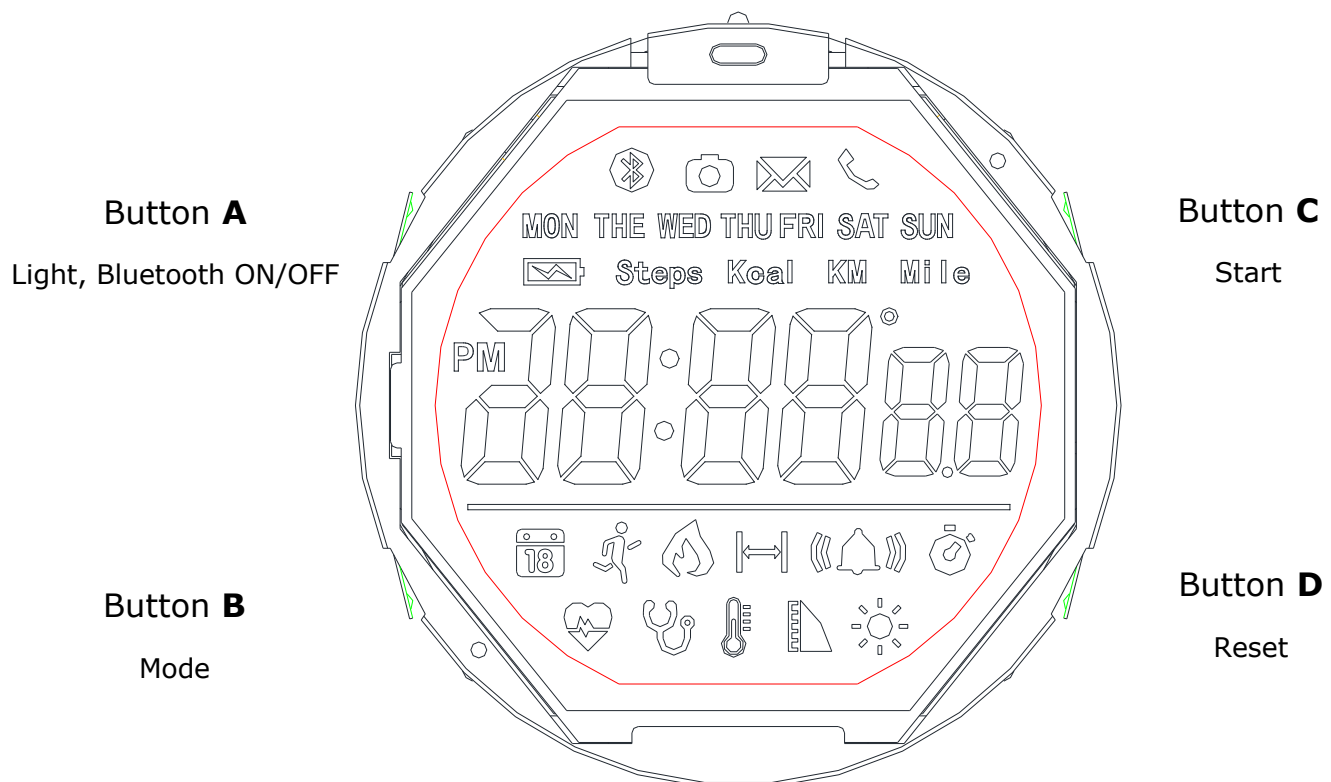

2. Features / Functions

- 2.1. 14 digits, LCD display week, hour, minute, second, day, month.
- 2.2. 12/24H format, when connected to mobile will keep synchronizing.
- 2.3. Step counting, calories consumption/distance measurement in the whole day
(After connecting your phone, data can be synchronized)
- 2.4. Sleep monitoring (After connecting your phone, data can be synchronized)
- 2.5. Alarm function (Can be set in the App)
- 2.6. Stopwatch: the max value is 23 hours 59min and 59 seconds.
- 2.7. EL backlight: in any mode, backlight flash for 2s if press button A
- 2.8. Bluetooth ON/OFF (decrease power consumption in different modes)
- 2.9. Sharing your records among your friends (Android and iOS App)
- 2.10. Exercise data storage (data on your watch will be stored for 7 days without
being connected to your phone)
- 2.11. Automatically update of time and date by connecting with the phone.
Alarm / Reminder can be set in the App.
- 2.12. Notification of any incoming call, message (Facebook, WhatsApp, Twitter,
Skype, QQ, WeChat, Line).
- 2.13. Camera control:
Taking a photo on your phone by a turning movement of your wrist.
- 2.14. Searching your watch by your phone
- 2.15. Searching your phone by your watch
- 2.16. Humidity display
- 2.17. Altitude display
- 2.18. UV index

3. Manual instructions

3.1. Power ON/OFF mode

Power ON

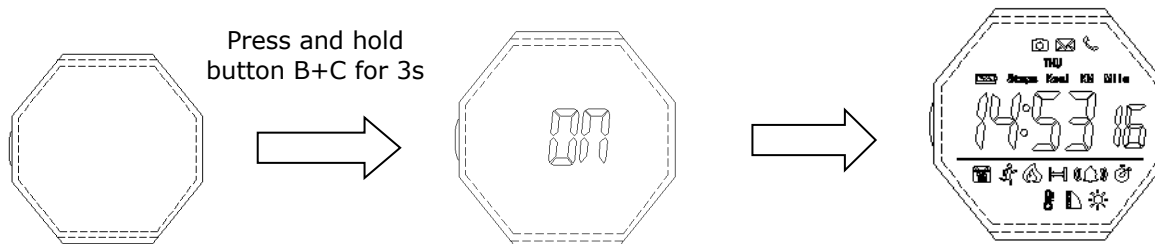

Power OFF

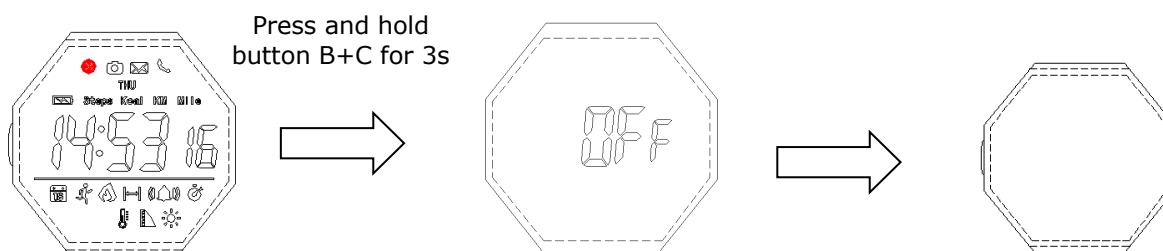

3.2. Bluetooth ON/OFF mode

Note:

For the first installation the Bluetooth on the watch and the phone must be switched on.

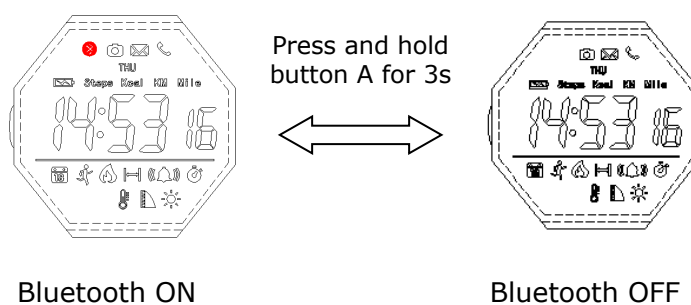

3.3. Review your records

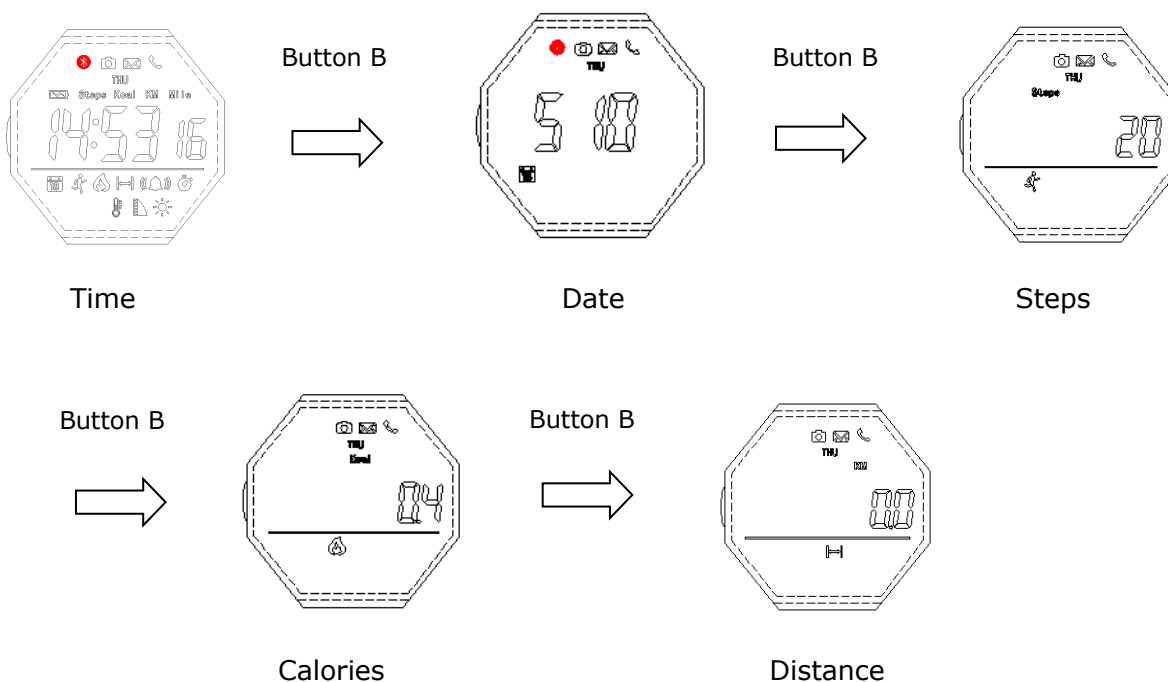

3.4. Check the humidity, altitude and UV by your phone

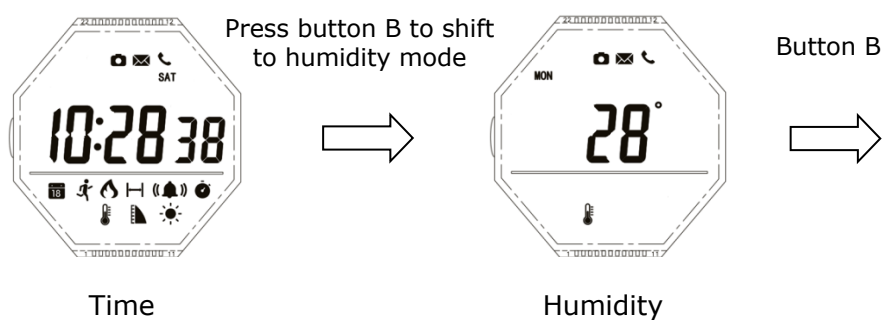



Altitude

Button B



UV index (L = level)

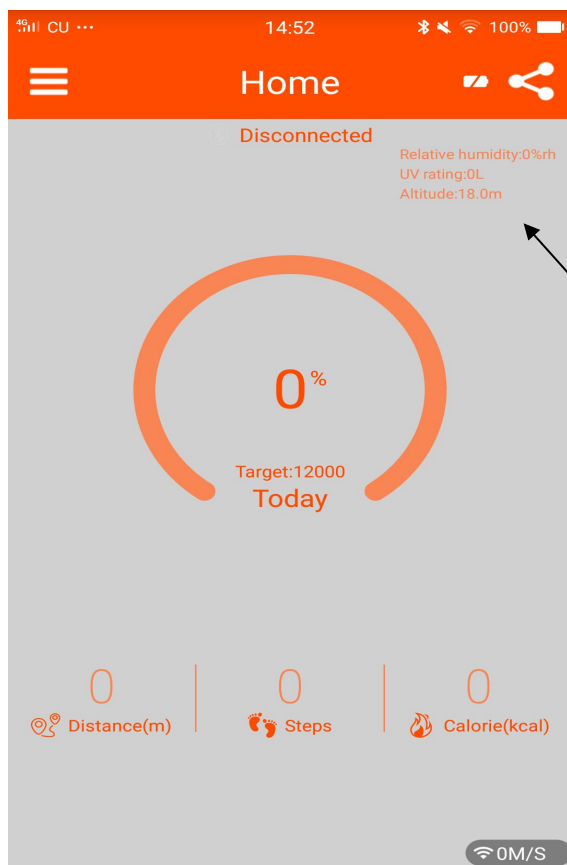

Click to refresh

Note:

Click Refresh to get the relative humidity, UV level, altitude at the time of the location, and the mobile phone and watch are connected and synchronized to the watch. Get only once a day.

3.5. Alarm setting mode

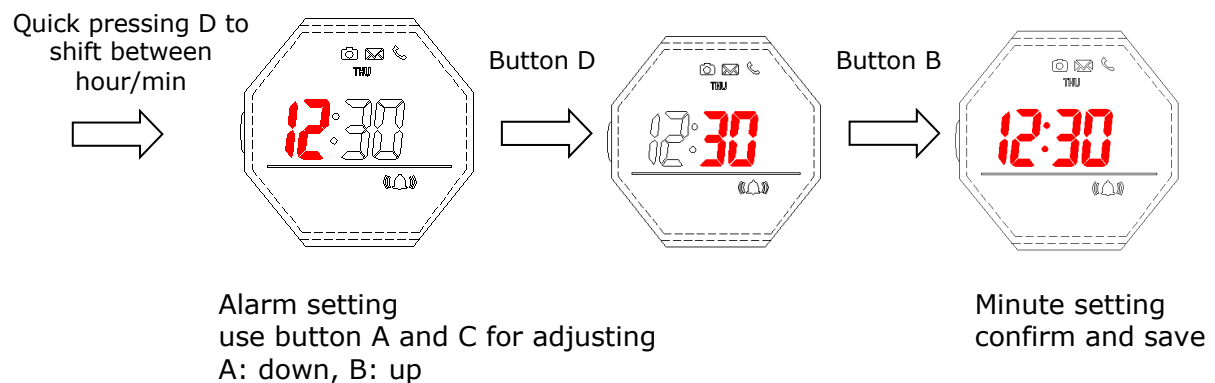
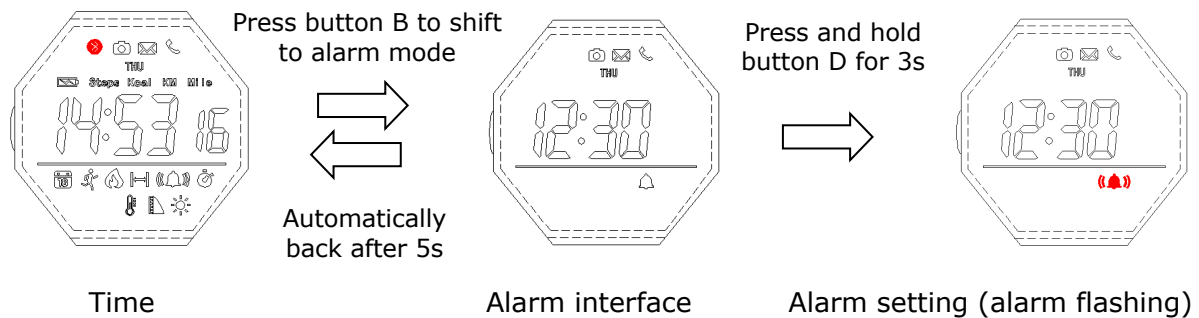

Note:

- The alarm tone sounds for 20 seconds and the alarm sign will flash

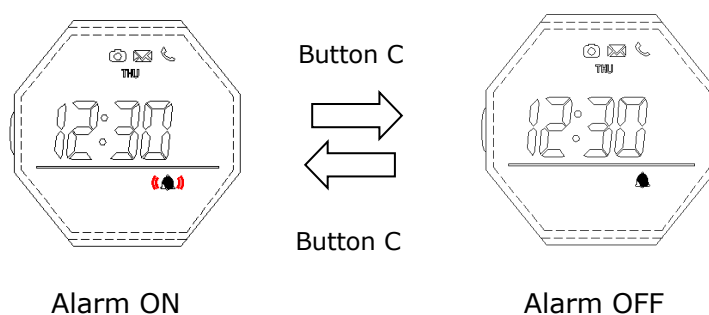

To turn the alarm mode ON/OFF, press button C

3.6. Stopwatch mode

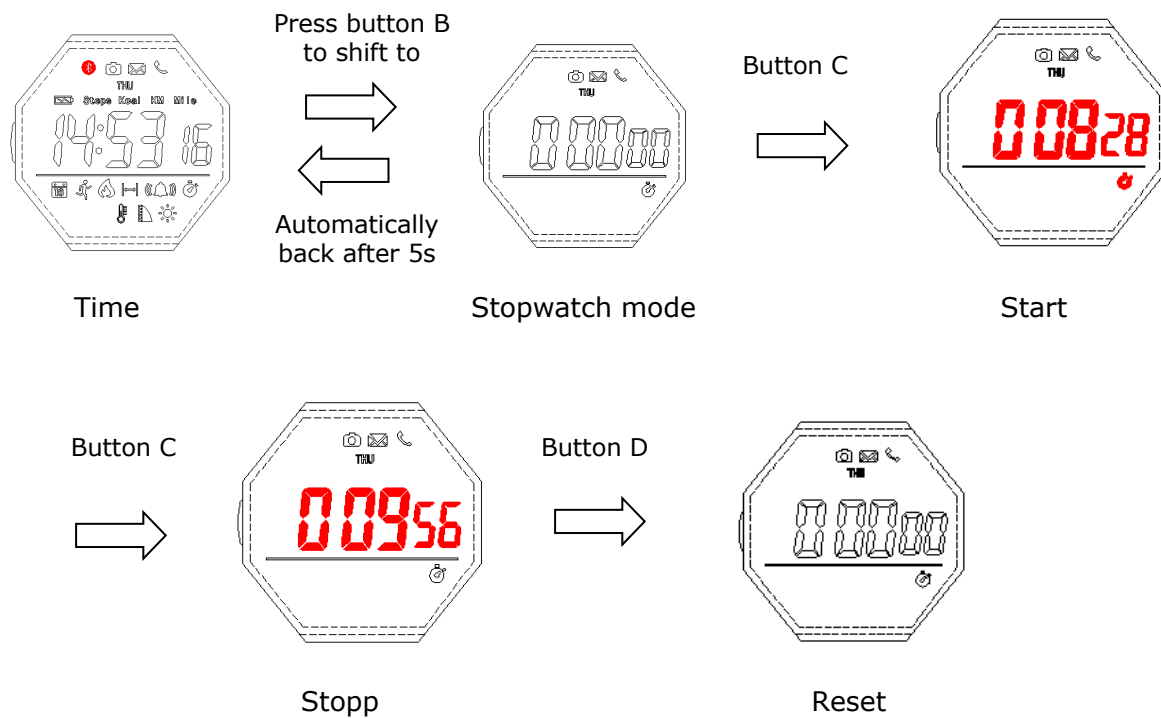

Note:

- Stopwatch max value: 23 hours 59 min 59 seconds. After that it will start counting from 0 again.
- If the stopwatch is not reset and shifted to other mode, it will keep running.

3.8. Calendar setting

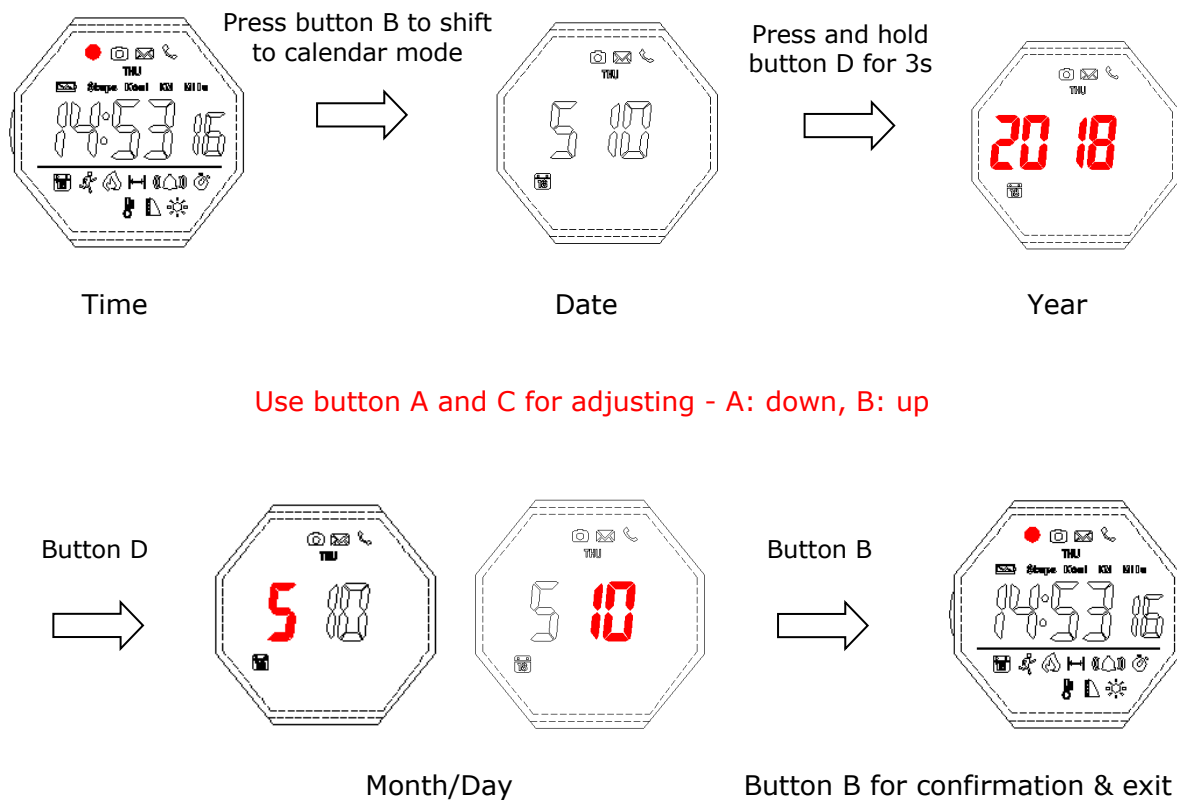

3.9. Take photos by watch remote control

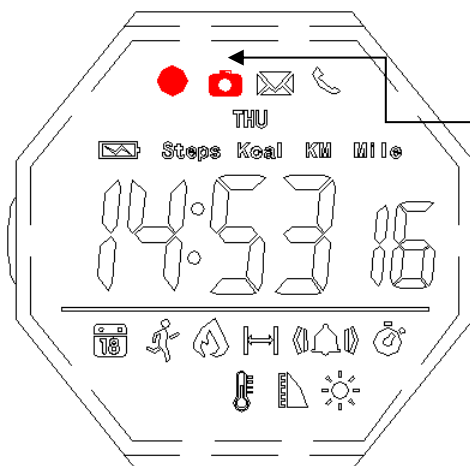

When your phone and watch are connected, choose "Take photos by watch remote control" in the APP.

The sign will flash, which means you have turned it on.

Open your camera on your phone, shake your watch and the phone will take a photo.

4. App instruction manual

The following languages are available depending on the location:

German, English, French, Italian, Portuguese, Spanish, Russian, Arabic, Japanese, Korean, Simplified Chinese, Traditional Chinese.

4.1. App installation

4.1.1. Installation - Android App

Note: Bluetooth on the watch must be switched on. (Press button A for 3 sec.)
Bluetooth and Location on the phone must be switched on.

- Search HMate App in the Google Play Store
- Install the HMate App
- Open the App
 - Allow HMate to access to your photos, data and media.
 - Allow HMate to access to your location.
 - Allow HMate to make and manage calls.

4.1.2. Installation - iOS App

- Search HMate App in the App Store
- Install the HMate App
- Open the App
 - Allow HMate to send you messages.
 - Allow HMate to access to your location.

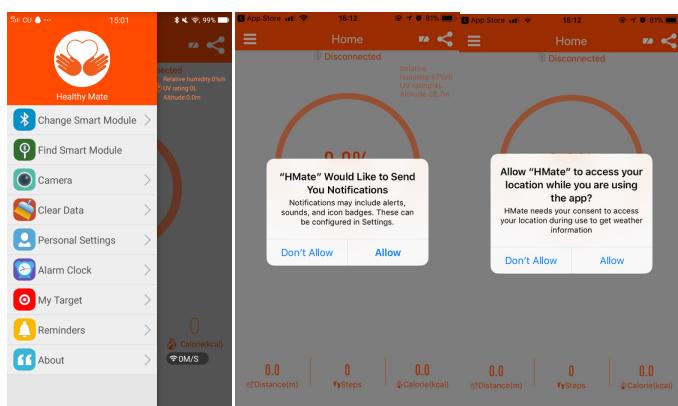

Note:

In IOS system, if the humidity, altitude, UV. Information is not updated, then check the item: Find the "HMate" in Settings, open POSITION and then choose "during the applying"

4.2. Connect your watch to your mobile

Note: Bluetooth on the watch must be switched on. (Press button A for 3 sec.)
Bluetooth and Location on the phone must be switched on.

- Open the HMate App
- Open the menu on the top left
- Choose "My Device"
 - UWATCH appears on the display
 - Click on UWATCH on your touch screen to connect

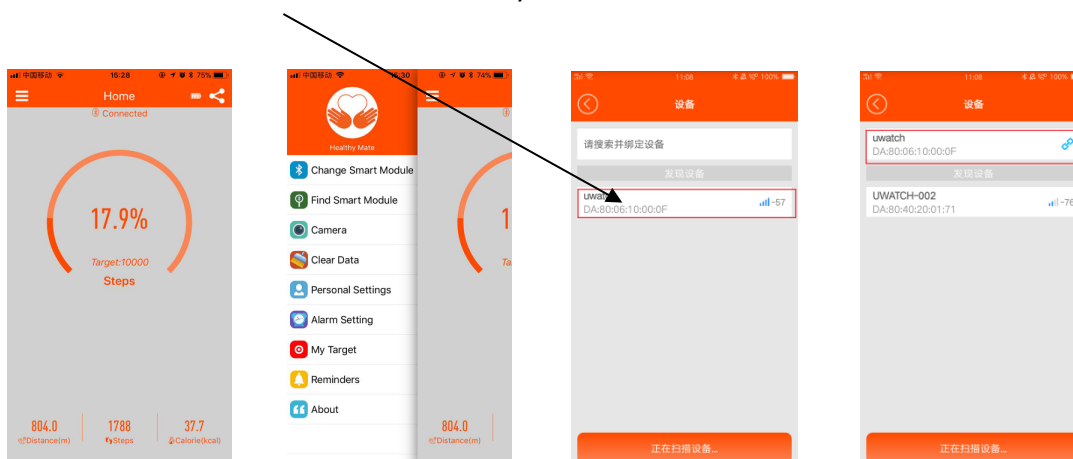

4.3. Search for your device

- Open the HMate App
- Open the menu on the top left
- Choose "Search for device"
 - Your watch will BEEP

4.4. Search for your mobile

- Press and hold button C for 3 sec.
- The mobile will play a sound

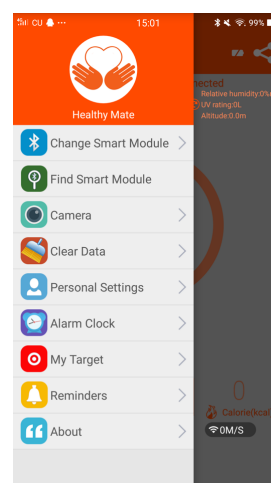

Note: The ring tone of your mobil must be switched on.
The phone and watch must be connected.
IOS users temporarily do not support the search for mobile phones!

4.5. Reset your data

- Open the HMate App
- Open the menu on the top left
- Choose "Delete your data"
 - Press yes
 - After finishing deleting, it will remind you that your data has been deleted successfully.

4.6. Personal setting

- Open the HMate App
- Open the menu on the top left
- Choose "Personal Settings"
 - Update your personal data
 - Choose: synchronize

4.7. Alarm settings

- Open the HMate App
- Open the menu on the top left
- Choose "Alarm"
 - Set your alarm
 - Choose: synchronize

4.8. Notifications

- Open the HMate App
- Open the menu on the top left
- Choose "Notifications"
 - Choose Apps you want
 - Choose: synchronize

If the notifications do not work, please check:

- is the mobile connected to the App
- are the permissions for the App turned on

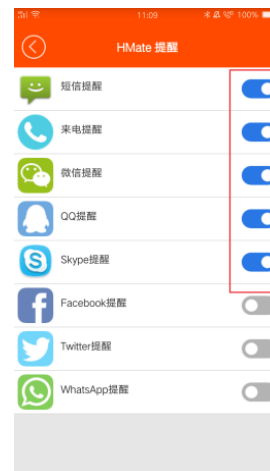

4.9. Synchronizing and data review

- Open the HMate App
- Click in the middle of the orange circle to synchronize and review your data

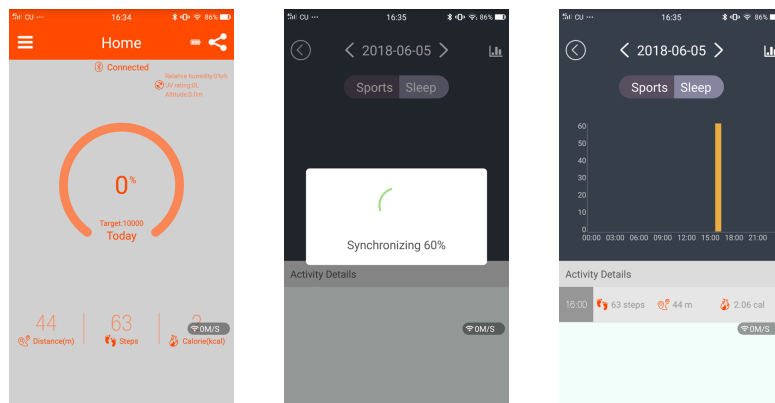

4.10. Sharing exercises

- Open the HMate App
- Click the on the sharing button on the top right
- Than you can share your data with your friends

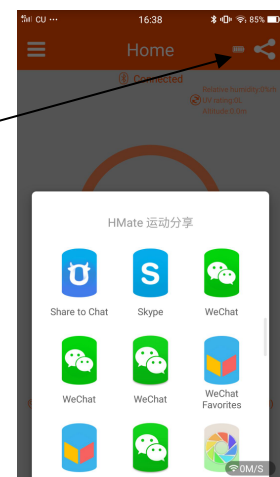

4.11. About us

- Open the HMate App
- Click on "About us"
 - Review the current FirmWire, App Version and FAQ's.

5. APP Download



Googleplay (Android)



APP store (IOS)



Application (Android)

C. Specification

- Module Size (including bulge): $\Phi 36.2\text{mm}$
- Thickness (including buzzer): 9.6mm
- Operation Temp.: $-10^{\circ}\text{C} \sim +60^{\circ}\text{C}$
- Operation voltage: 3.0V
- Accuracy: 45s/month
- Battery model: CR2430 (290mAh)
- Static max. current (Bluetooth off): $\leq 15\mu\text{A}$
- Static average current (Bluetooth off) $\leq 11.65\mu\text{A}$
- Connected max. current (Bluetooth on) $\leq 0.5\text{mA}$
- Connected average current (Bluetooth on) $\leq 30\mu\text{A}$
- Alarm average current: $\leq 1.24\text{mA}$
- Backlight average current: $\leq 10\text{mA}$
- Battery life, operate everyday (alarm sound for 60s/time, EL backlight illuminates 4 times for 12s totally, call, message, WeChat, things remind 10 times): (High Power Mode: ≥ 12 Months (Nippon Electric) (Energy-saving mode): ≥ 18 months (Nippon Electric)