

SPECIFICATIONS

| | |
|---------------------|---|
| MCU | NRF52832 (M4) Bluetooth 4.0 |
| Display Screen | 1.3_Inch IPS HD color screen resolution 240X240 |
| Support system | above iOS 8.0 / above Android 4.4 |
| Battery | Lithium polymer 180mAh |
| Adaptation | Can be used independently or with mobile APP |
| Acceleration Sensor | Triaxial acceleration Low power consumption |
| Storage | 64M Flash |
| Charging Type | Magnetic contact charging |
| Support Language | Chinese and English UI interface |

THE USE OF WATCH BUTTON FUNCTIONS



S1 BUTTON FUNCTIONS

1. In the other interface, short press S1 can return to the main interface.
2. In power off status, press S1 for 3 seconds, the watch will be power on, in the power on status and main interface, press S1 for 3 seconds, the watch will be power off.

S2 TOUCH AREA FUNCTIONS

1. Short touch S2 can view the each interface.
2. View each interface you can enter this interface by touch S2 for 3 seconds.
3. In the power off status, touch S2 for 3 seconds, the watch will be power on.

FUNCTION INSTRUCTION

1. TFT display, after connect to the APP, watch time syncs with your phone, the watch can display: steps, calories, heart rate, etc.
2. 24h step /calories consume/distance detection.
3. Alarm function can set the alarm time in the APP
4. Stopwatch function.
5. Heart rate/blood pressure detection.
6. Sleep detection.
7. Find the phone and find the watch function.
8. Multi-motion detection.
9. Smart sync the phone's time, data and alarm time, Avoid tedious manual operation.
10. Incoming call, message, QQ, watch, Twitter, Facebook, WhatsApp, Viber, Skype, line etc. caution.
11. Remote camera.
12. APP Support 12 languages: Simplified Chinese, Traditional Chinese, English, Italian, French, German, Russian, Spanish, Portuguese, Malaysian, Korean, Japanese.
13. The watch Support 2 languages: Chinese, English.

-1-

-2-

-3-

CONVERSION OF MODE

Short touch screen S2 screen to switch order.



SHUTDOWN CONVERSION OF MODE

In power off status, touch the S2 for 3 seconds, the watch will be power on.



-4-

HEART RATE DETECTION (Part 1) (Please wear the strap on your heart)



BLOOD PRESSURE DETECTION



FIND THE PHONE



STOPWATCH



-5-

MULTI-MOTION INTERFACE

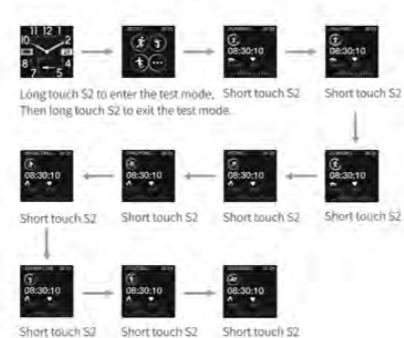

-6-

REGISTRATION AND LOGIN

After installation, you need to register an account to log in. If you have an account, click on your account to log in.



-7-

CONNECT APP



-8-

FUNCTIONAL INTERFACE

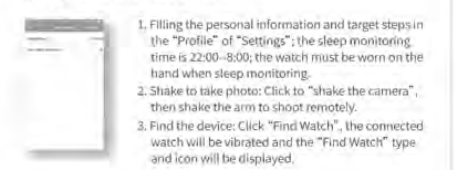

NOTIFICATION REMINDER



-9-

ALARM FUNCTION SETTING



-10-

UNBOUND WATCH

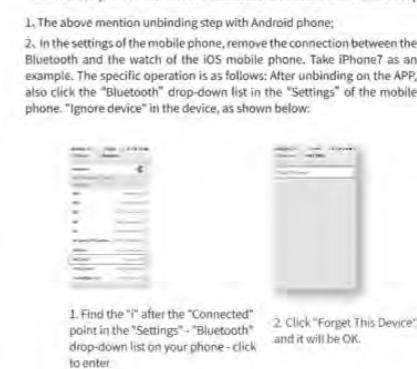

-11-

PACKING LIST

Watch, charging cable, manual

DOWNLOAD APP

App is compatible with Bluetooth 4.0, Android 4.4, IOS 8 and later smart phones. Scan the QR code below or search "RaceFit Pro" on App Store & Google Play to download and register an account. Please do not connect the watch at the phone's setting Bluetooth (If it is connected, please unconnected), otherwise the app can't search the watch to pair.

-12-



RaceFit Pro



IOS



Googleplay